

BISAGRAS PARA PUERTAS DE DUCHA

ESTILO CONTEMPORANEO



DISEÑOS MODERNOS ACORDES A CADA PROYECTO...



TRANSPARENCIA

HERRAJES - BISAGRAS - CONECTORES - FRENOS DE PISO - CERRADURAS - TIRADORES - ARAÑAS



- Aplicable para espesores de cristal de 8 y 10mm
- Material: Acero Inoxidable 304, disponible en acabados Satinado y Pulido
- Capacidad de Carga: 30 - 40kg.
- Ancho de Puerta: 600 - 800mm
- Cuentan con un Sistema de Cierre Automático a partir de los 30°
- Todas las piezas incluyen 4 empaquetaduras transparentes antideslizantes

DR-SH2330

- Bisagra de 90° cristal a muro

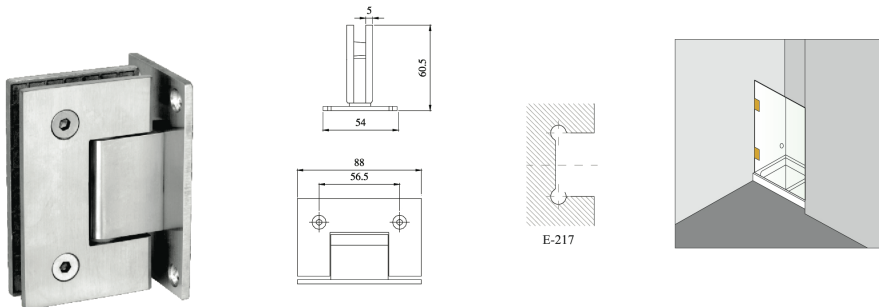

DR-SH2360

- Bisagra de 180° cristal a cristal

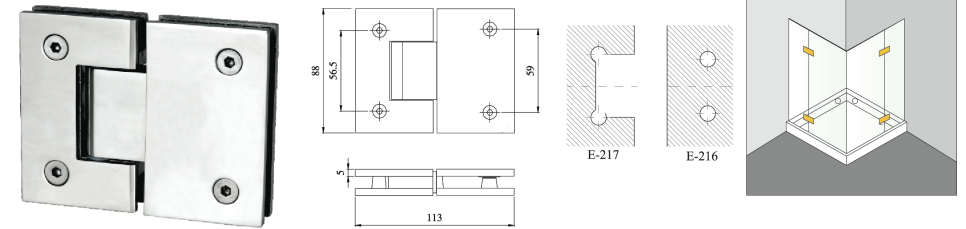

DR-SH2380

- Bisagra de 135° cristal a cristal

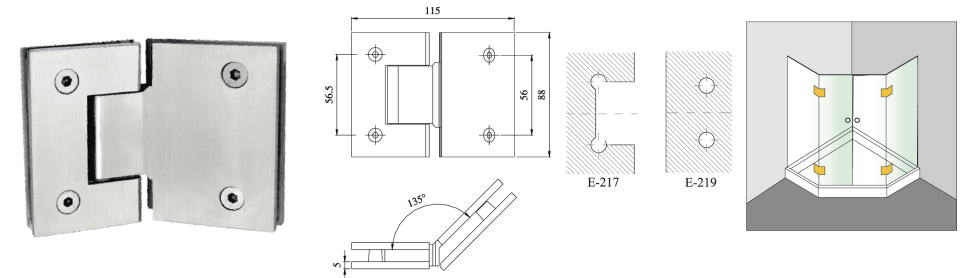

DR-SH2390

- Bisagra de 90° cristal a cristal

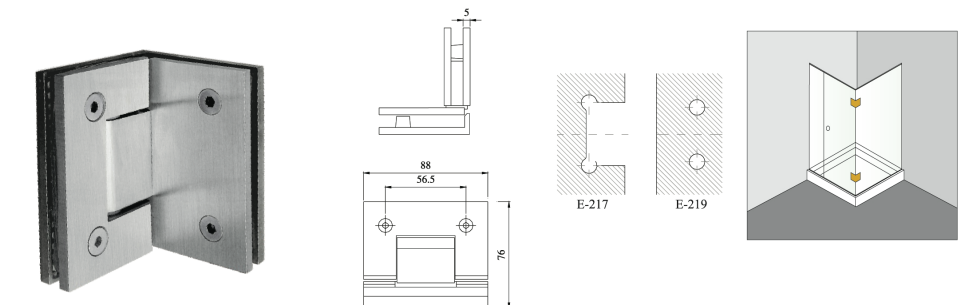

DR-SH5861

■ Conector de 90° cristal a piso o muro

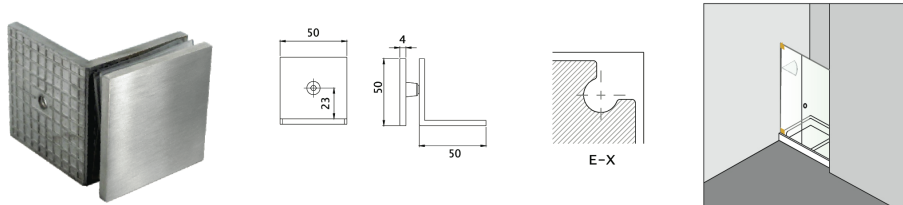

DR-SH5050

■ Conector de 180° con fijación cristal a cristal

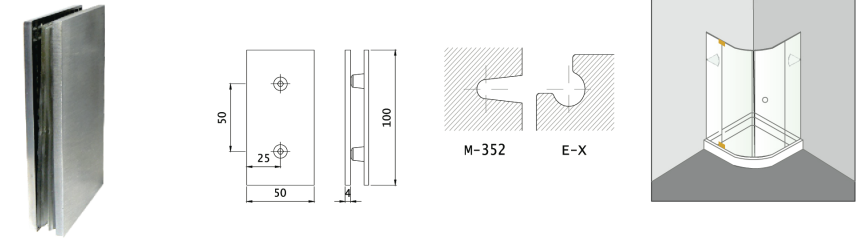

DR-SH5060

■ Conector tipo U cristal a piso o muro

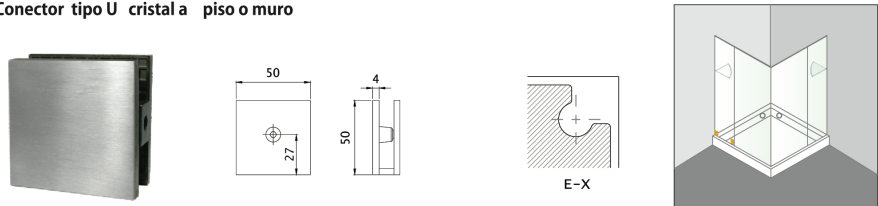

DR-SH5090

■ Conector de 135° con fijación cristal a cristal

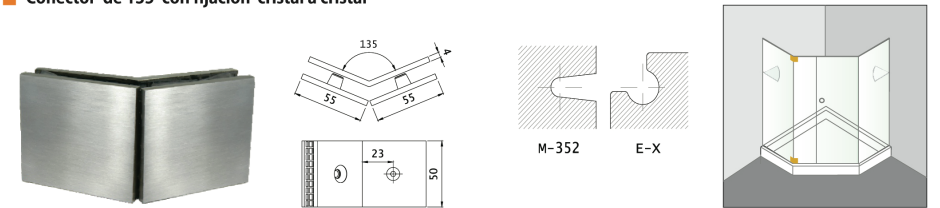

DR-SH5015A

■ Conector de 90° cristal a cristal

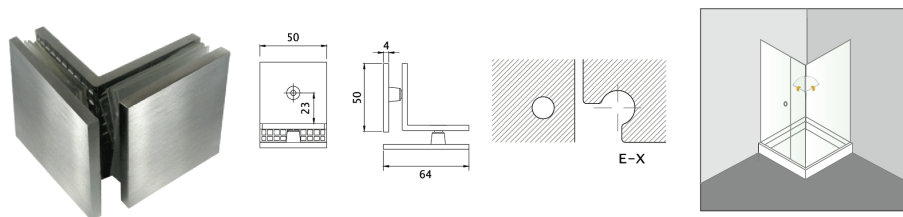

DR-SH5800

■ Conector de 180° cristal a cristal con fijación a piso, techo o muro

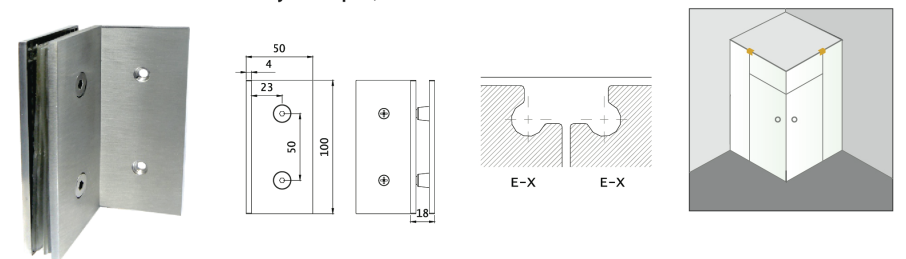

DR-SH5015C

■ Conector de 90° cristal a cristal

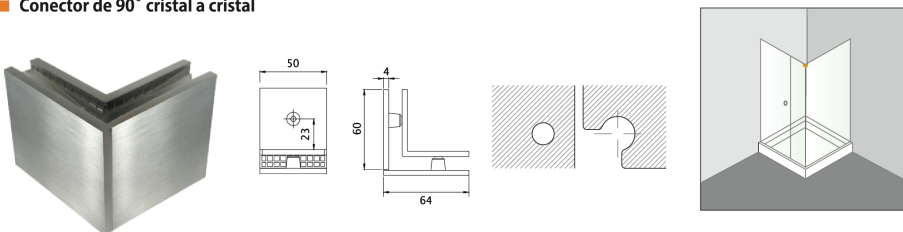

DR-SH5560

■ Conector de 90° cristal a cristal con fijación a piso o techo

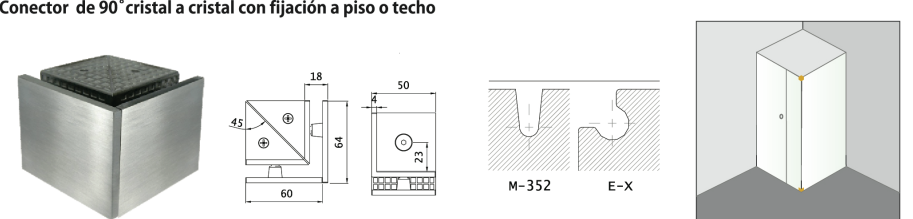

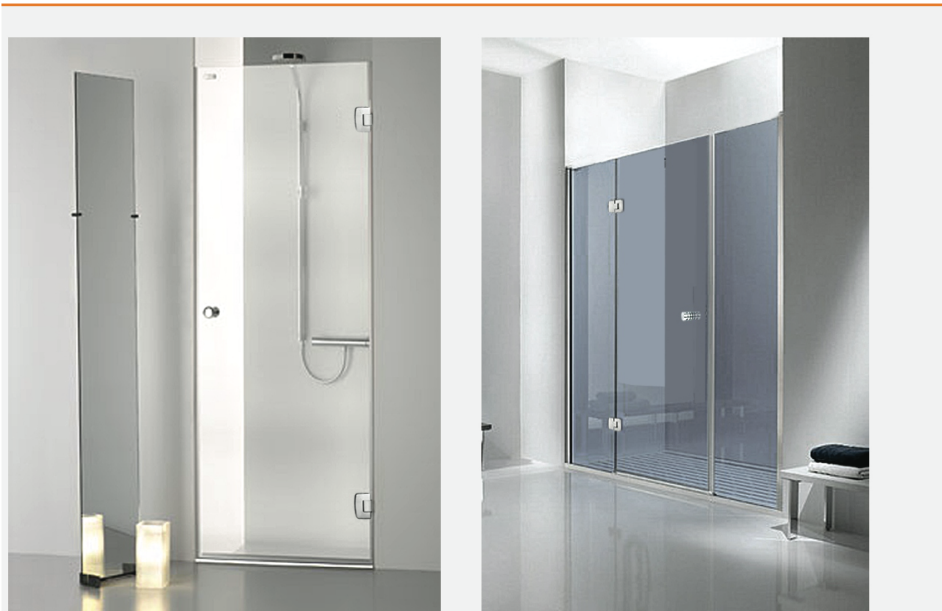

- Aplicable para espesores de cristal de 8 y 10mm
- Material: Acero Inoxidable 304, disponible en acabados Satinado y Pulido
- Capacidad de Carga: 30 - 40kg.
- Ancho de Puerta: 600 - 800mm
- Cuentan con un Sistema de Cierre Automático a partir de los 30°
- Todas las piezas incluyen 4 empaquetaduras transparentes antideslizantes

DR-SH3360
■ Bisagra de 180° cristal a cristal

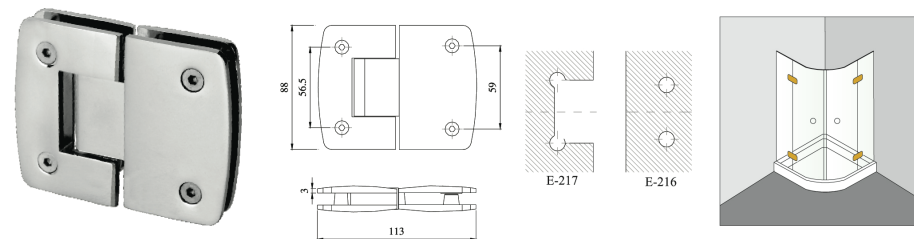

DR-SH3380
■ Bisagra de 135° cristal a cristal

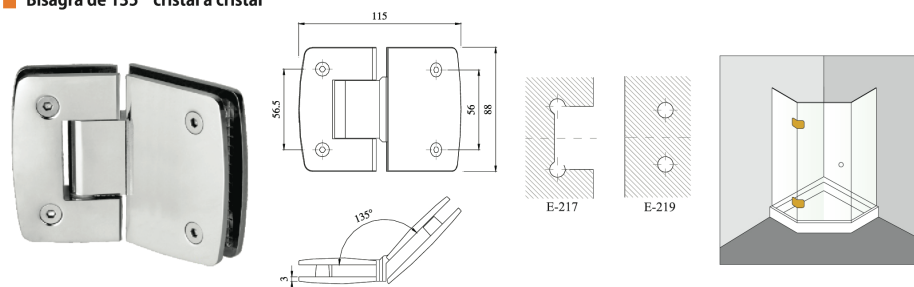

DR-SH3330
■ Bisagra de 90° cristal a muro

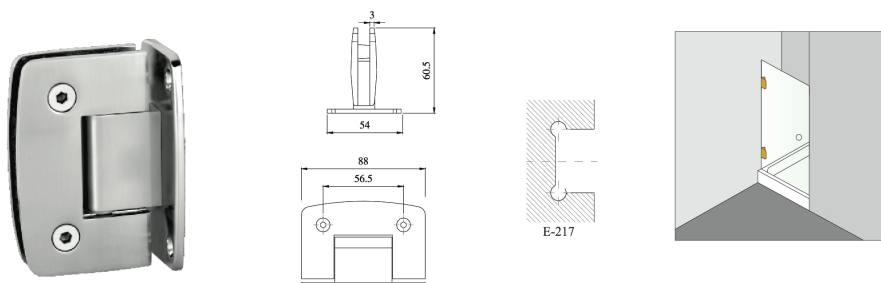

DR-SH3390
■ Bisagra de 90° cristal a cristal

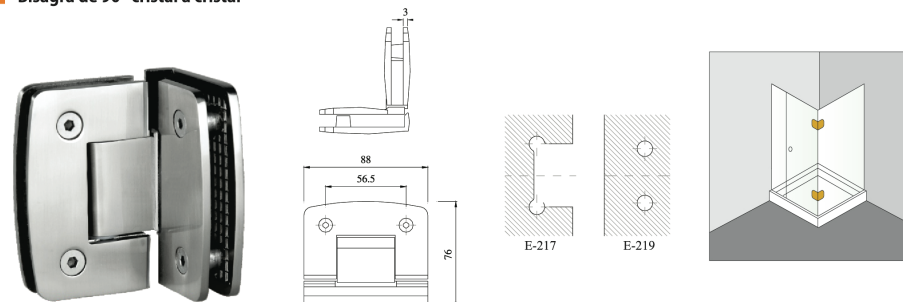

DR-SH6861

■ Conector de 90° cristal a piso o muro

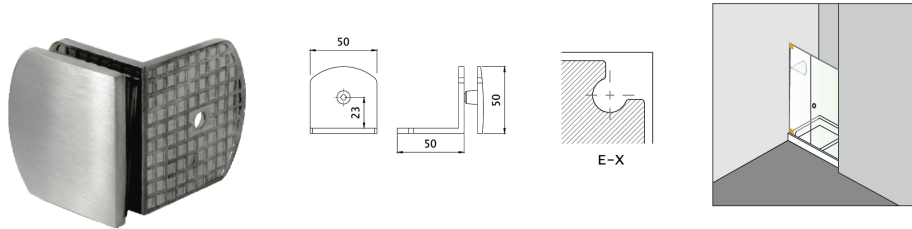

DR-SH6050

■ Conector de 180° con fijación cristal a cristal

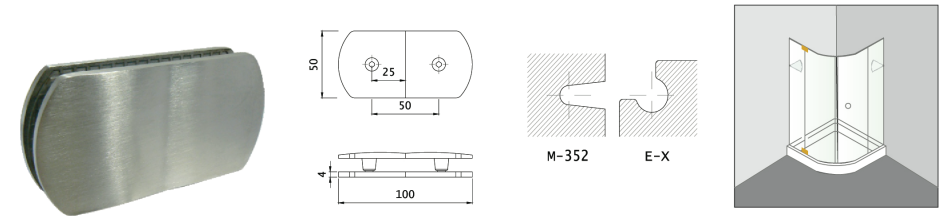

DR-SH6060

■ Conector tipo U cristal a piso o muro

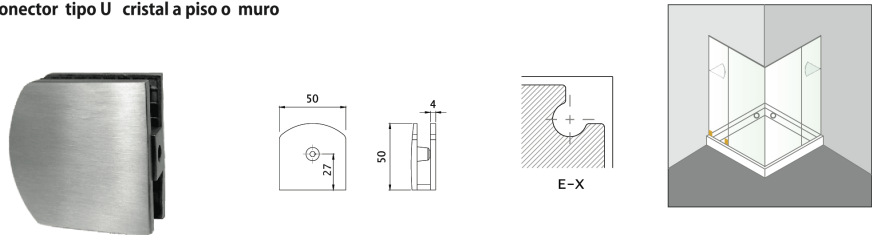

DR-SH6090

■ Conector de 135° con fijación cristal a cristal

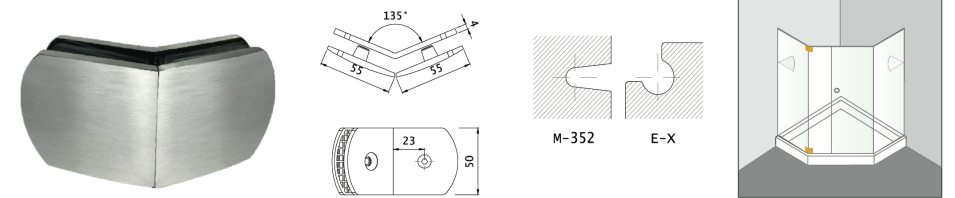

DR-SH6015A

■ Conector de 90° cristal a cristal

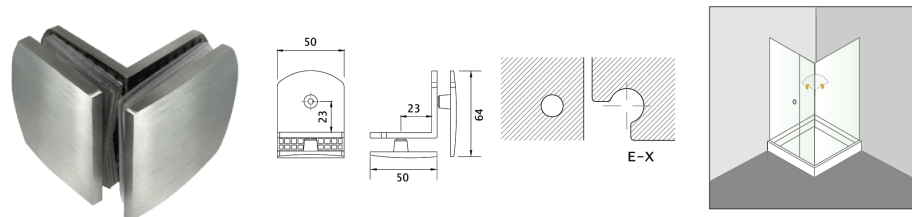

DR-SH6800

■ Conector de 180° cristal a cristal con fijación a piso, techo o muro

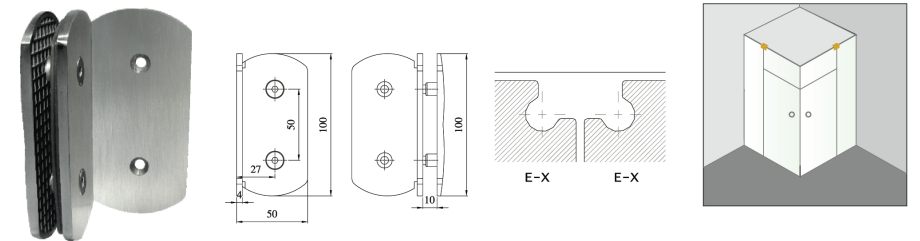

DR-SH6015C

■ Conector de 90° cristal a cristal

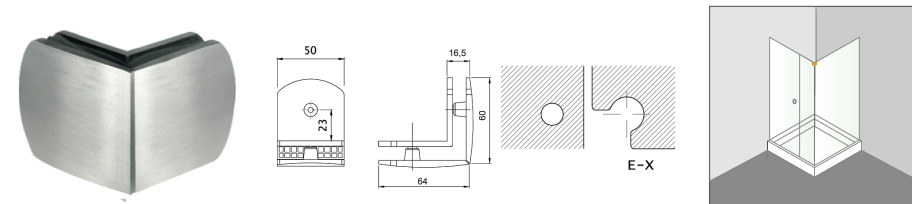

DR-SH6560

■ Conector de 90° cristal a cristal con fijación a piso o techo

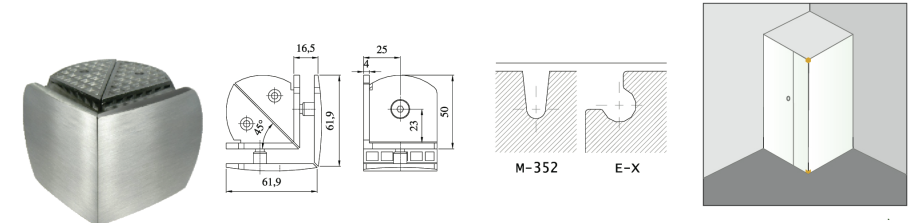



- Aplicable para espesores de cristal de 8, 10 y 12mm
- Material: Acero Inoxidable 304, disponible en acabado Satinado
- Todos los piezas incluyen empaquetaduras transparentes antideslizantes

DR8200E-1
■ Bisagra de 90°, 135° y 180° cristal a cristal

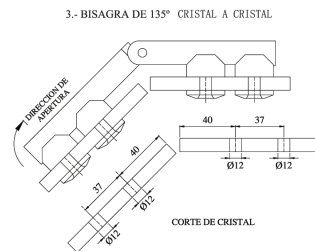
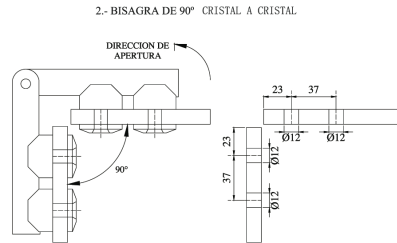
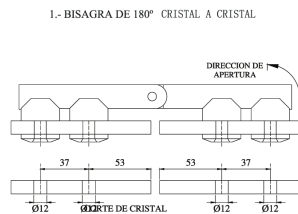

DR8200E-2
■ Bisagra de 90° cristal a muro

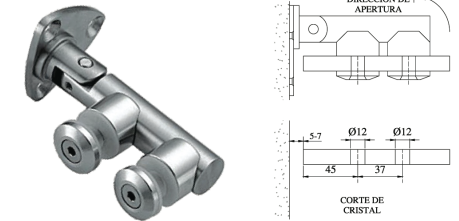

DR8200E-3
■ Conector de 90° con fijación a piso, techo o muro

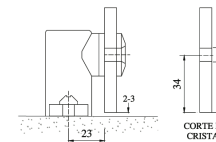

DR8200E-4
■ Conector de 180° cristal a cristal

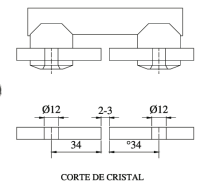

DR8200E-5
■ Conector de 90° cristal a cristal

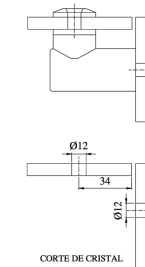

DR8200E-6
■ Tope de 90° con fijación a piso, techo o muro

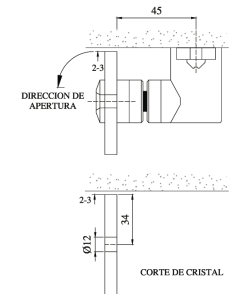

DR8200E-7
 ■ Tope y conector de 135°

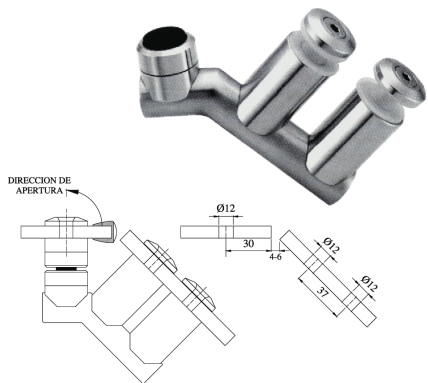

DR8200E-7A
 ■ Tope y conector de 90°

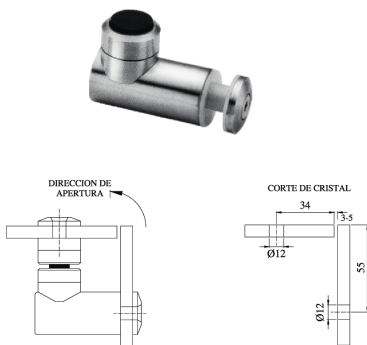

DR8200E-13
 ■ Conector de Tubo de Ø25.4mm a cristal

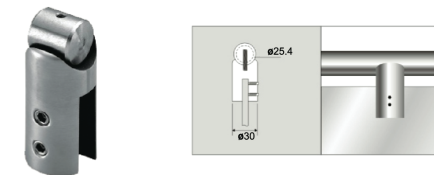

DR8200E-14
 ■ Conector de Tubo de Ø25.4mm en ángulo

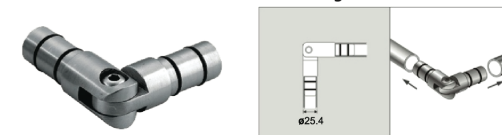

DR8200E-8
 ■ Tope y conector de 180°

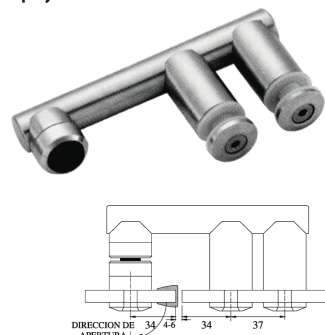

DR8200E-12 A
 ■ Tubo de Ø20mm, Longitud: 1600mm
DR8200E-12 B
 ■ Tubo de Ø25.4mm, Longitudes: 2500 y 4000mm



DR8200E-15
 ■ Conector de fijación de Tubo de Ø25.4mm a muro

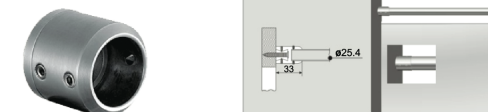

DR8200E-10
 ■ Conector de Tubo de Ø20mm a cristal

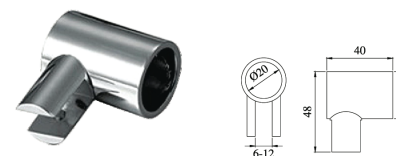

DR8200E-11
 ■ Conector de Fijación de Tubo de Ø20mm a muro



DR8200E-9
 ■ Tope a cristal

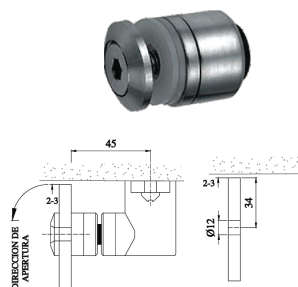

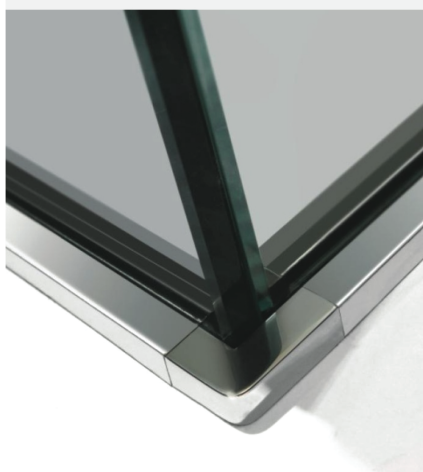

- Aplicable para espesores de cristal de 8, 10 y 12mm
- Material: Acero Inoxidable 304, disponible en acabados Satinado y Pulido

DR8200A-5A, B, C

- Guía de piso, Longitud de 2500mm



CODIGO	W1	W2	H
DR8200A-5A	8	30.5	15
DR8200A-5B	10	30.5	15
DR8200A-5C	12	30.5	15

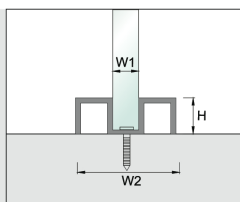

DR8200A-6A, B, C

- Cobertor para Guía de piso, Longitud de 2500mm



CODIGO	W1	H
DR8200A-6A	8	15
DR8200A-6B	10	15
DR8200A-6C	12	15

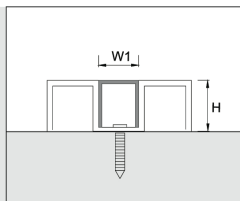

DR8200A-7A, B, C

- Conector de 90° para guía de piso

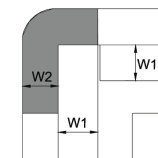

CODIGO	W1	H
DR8200A-7A	8	11
DR8200A-7B	10	10
DR8200A-7C	12	9

DR8200A-8A

- Conector de 90° para guía de piso

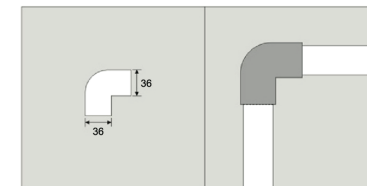
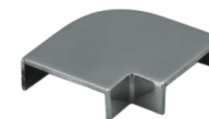

DR8200A-8B

- Conector de 135° para guía de piso

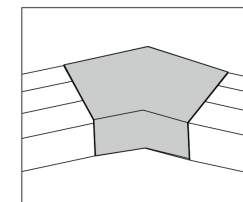
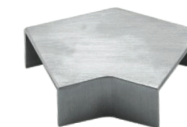

DR8200A-8C

- Conector de 180° para guía de piso

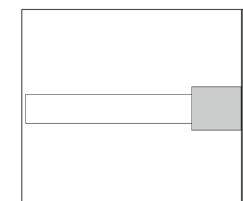
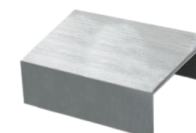



- Aplicable para espesores de cristal de 8 y 10mm
- Material: PVC
- Tipos: Burletes complejos, rígidos y flexibles
- Longitud: 3600mm

ASS001
■ Burlete Traslúcido, Rígido y Flexible.

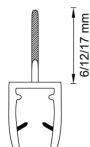

CODIGO	Espesor del Cristal (mm)	Longitud (mm)
ASS001-8	8	3600
ASS001-10	10	

ASS003
■ Burlete Traslúcido, H Rígido y Flexible.

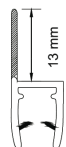

CODIGO	Espesor del Cristal (mm)	Longitud (mm)
ASS003-8	8	3600
ASS003-10	10	

ASS003A
■ Burlete Traslúcido, H Rígido.

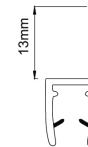

CODIGO	Espesor del Cristal (mm)	Longitud (mm)
ASS003A-8	8	3600
ASS003A-10	10	

ASS007
■ Burlete Traslúcido, Rígido y Flexible.

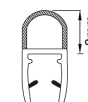

CODIGO	Espesor del Cristal (mm)	Longitud (mm)
ASS007-8	8	3600
ASS007-10	10	

ASS0010
■ Burlete Traslúcido, Rígido y Flexible.

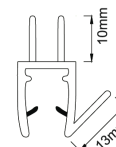

CODIGO	Espesor del Cristal (mm)	Longitud (mm)
ASS0010-8	8	3600
ASS0010-10	10	

ASS008A1
■ Burlete Magnético a 90° y 180° .

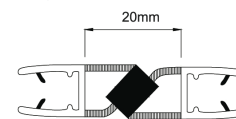

CODIGO	Espesor del Cristal (mm)	Longitud (mm)
ASS008A1-8	8	3600
ASS008A1-10	10	

ASS008C1
■ Burlete Magnético a 135° y 180°

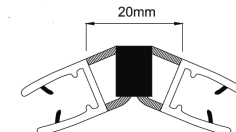
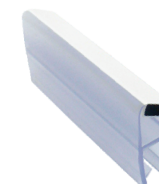

CODIGO	Espesor del Cristal (mm)	Longitud (mm)
ASS008C1-8	8	3600
ASS008C1-10	10	



DR-SH800A
■ Tirador de ducha

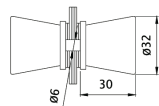

- Aplicable para espesores de cristal de 6, 8 y 10mm
- Material: Acero Inoxidable 304, disponible en acabados Satinado y Pulido

DR-SH800B
■ Tirador de ducha

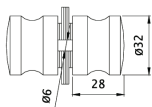

DR-SH800C
■ Tirador de ducha

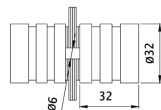

DR-SH800D
■ Tirador de ducha

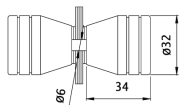

DR-SH800E
■ Tirador de ducha

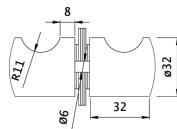

■ BISAGRAS

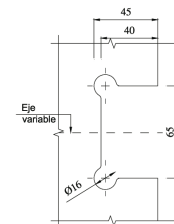

E- 217

- Bisagra de 90°cristal a muro

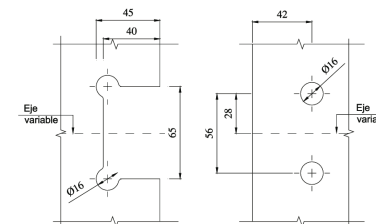

E- 217

E- 219

- Bisagra de 135°cristal a cristal

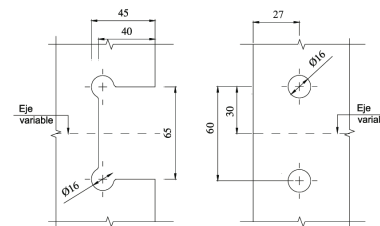

E- 217

E- 216

- Bisagra de 180°cristal a cristal

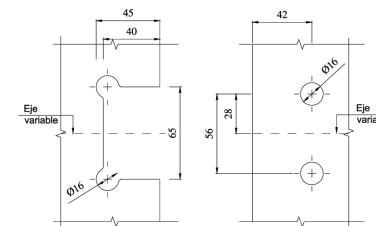

E- 217

E- 219

- Bisagra de 90°cristal a cristal

■ CONECTORES

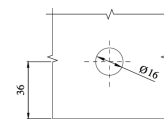

APLICABLE PARA ESPESORES DE CRISTAL DE 6 Y 8mm

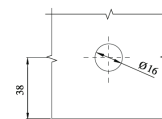

APLICABLE PARA ESPESORES DE CRISTAL DE 10mm

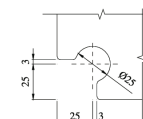

E- X

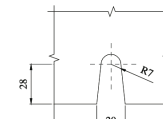

M-352

E- Circular